

Furco Industrial

Device Leveling Feet



Furco Industrial

Device Leveling

LEVELING FEET

Furco Industrial offers you flexible choices on selecting your preferred leveling devices.

Going beyond what you can find in our range, you can have it custom made from Furco Industrial.



SPINDLE

&



FOOT PLATE



LEVELING

FEET

Furco Industrial

Specification

LEVELING FEET

STANDARD SWIVEL TYPE

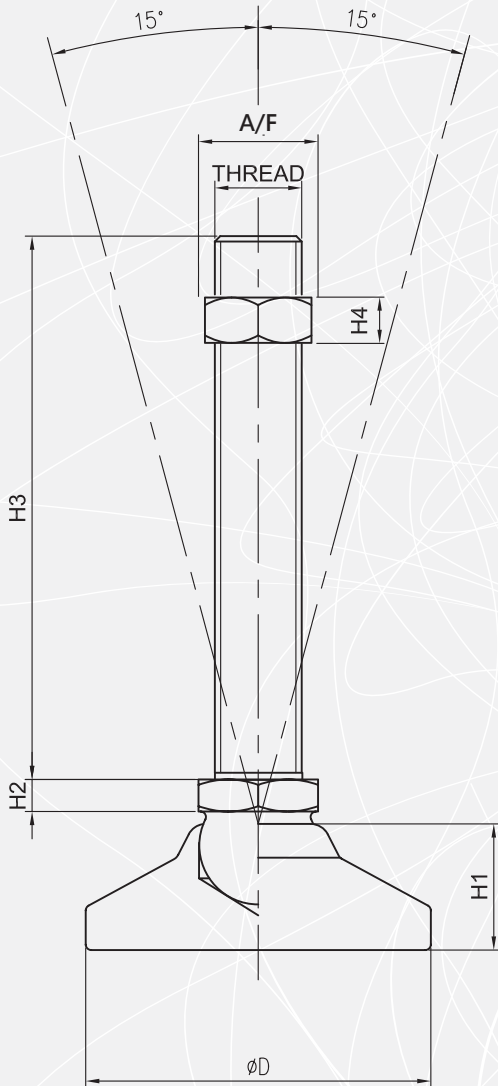

| Model | Base Plate | | Spindle Size | | | Nut | |
|-------------|------------|------|--------------|-----|-------|------|------|
| | ΦD | H1 | Thread | H2 | H3 | H4 | A/F |
| | 19 | 8.7 | #10-32 | 3.1 | 25.4 | 3.1 | 9.5 |
| | 25 | 11.5 | #1/4-20 | 4.5 | 31.7 | 4 | 12.7 |
| | 31.5 | 15 | #3/8-16 | 5.9 | 50.8 | 4 | 15.8 |
| | 31.5 | 15 | #3/8-16 | 5.9 | 101.6 | 4 | 15.8 |
| | 31.5 | 15 | M10x1.5P | 5.9 | 50 | 4 | 15.8 |
| | 31.5 | 15 | M10x1.5P | 5.9 | 100 | 4 | 15.8 |
| | 31.5 | 15 | #5/16-18 | 5.9 | 50.8 | 4 | 15.8 |
| | 47.6 | 20 | #1/2-13 | 6.6 | 50.8 | 9.5 | 19 |
| | 47.6 | 20 | #1/2-13 | 6.6 | 101.6 | 9.5 | 19 |
| | 47.6 | 20 | M12x1.75P | 6.6 | 50 | 9.5 | 19 |
| | 47.6 | 20 | M12x1.75P | 6.6 | 100 | 9.5 | 19 |
| | 63 | 23 | #5/8-11 | 5.9 | 50.8 | 9.5 | 22 |
| | 63 | 23 | #5/8-11 | 5.9 | 101.6 | 9.5 | 22 |
| | 63 | 23 | M16x2P | 5.9 | 50 | 9.5 | 22 |
| | 63 | 23 | M16x2P | 5.9 | 100 | 9.5 | 22 |
| | 76 | 25.5 | #3/4-10 | 9.1 | 50.8 | 10.5 | 27 |
| | 76 | 25.5 | #3/4-10 | 9.1 | 101.6 | 10.5 | 27 |
| | 76 | 25.5 | M20x2.5P | 9.1 | 50 | 10.5 | 27 |
| | 76 | 25.5 | M20x2.5P | 9.1 | 100 | 10.5 | 27 |
| | 101 | 30 | #1-8 | 13 | 108 | 13.5 | 36 |
| | 101 | 30 | #1-8 | 13 | 203.2 | 13.5 | 36 |
| | 101 | 30 | M24x3P | 13 | 108 | 13.5 | 36 |
| | 101 | 30 | M24x3P | 13 | 203 | 13.5 | 36 |
| custom-made | | | | | | | |

unit :mm

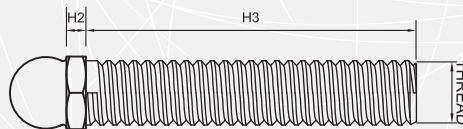

Furco Industrial

Material

LEVELING FEET

STANDARD SWIVEL TYPE

SPINDLE

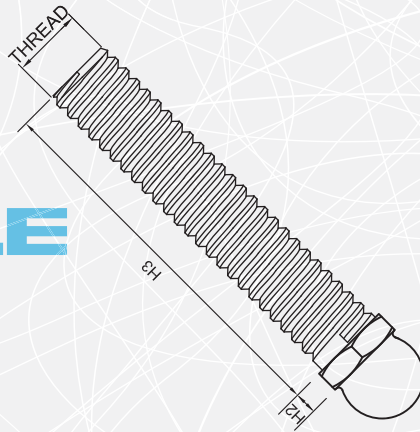

Stainless Steel
Steel Galvanized
Steel with plated Zinc Yellow
and others by request

PLATE

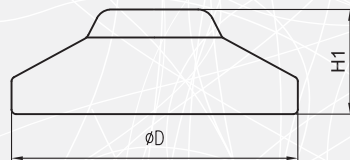

Stainless Steel
Steel Galvanized
Steel with plated Zinc Yellow
Aluminum Alloy
POM
Nilon
and others by request

NUT

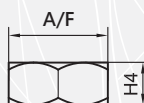

Stainless Steel
Steel Galvanized
Steel with plated Zinc Yellow
and others by request

Furco Industrial

S a m p l e s

LEVELING FEET

STANDARD SWIVEL TYPE



Furco Industrial

Optional spindle

LEVELING FEET

OPTIONAL SWIVEL TYPE

SHORT SPINDLE

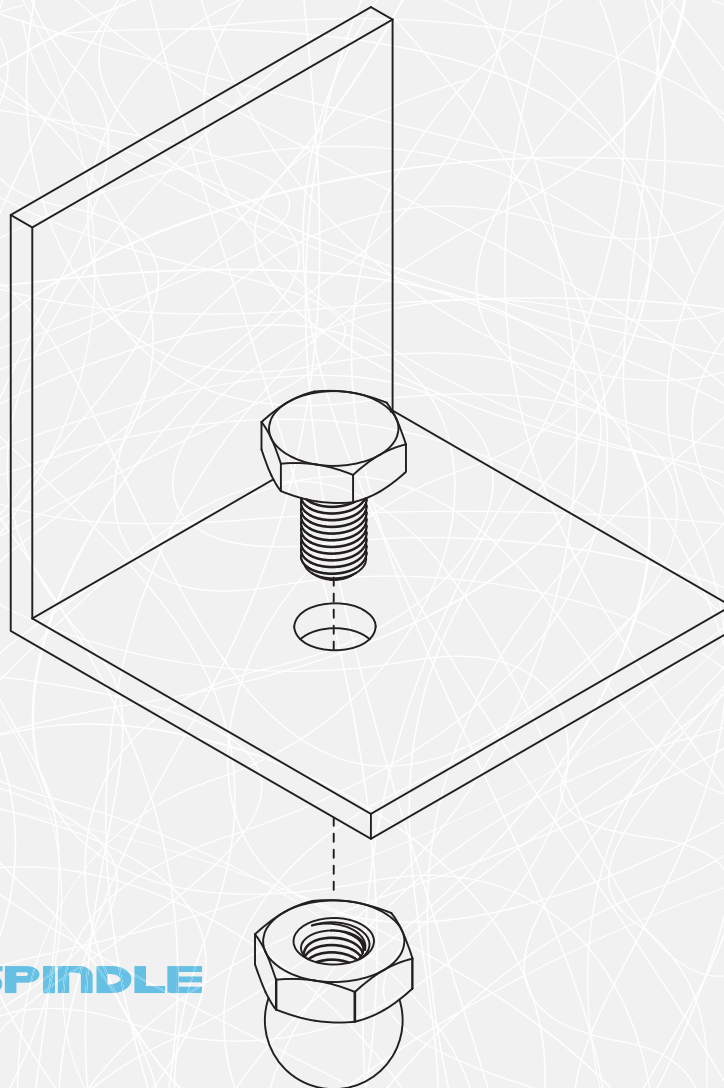

SHORT SPINDLE



Short Spindles are fit for directly affixing foot plates by standard inserts/ attachments where leveling is not necessary.

Dimensions are also available by request.

Furco Industrial

Optional Plate

LEVELING FEET

OPTIONAL SWIVEL TYPE

WITH HOLES TO BOLT

SECTION

VIEW

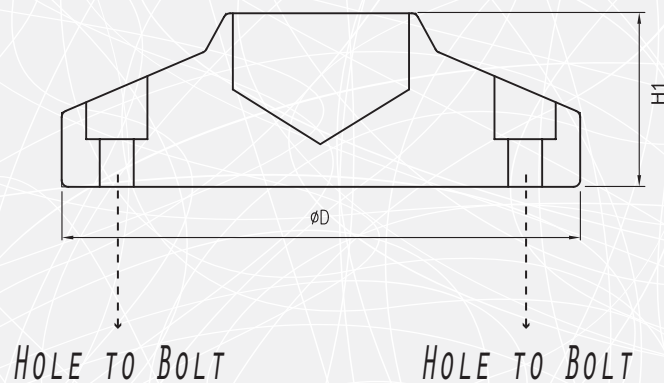

TOP

VIEW

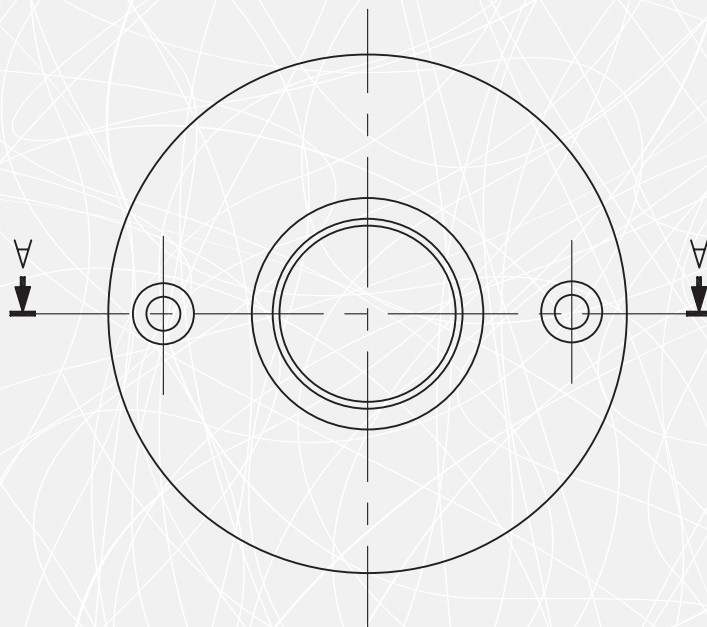

Optional Plate with holes to bolt allows you fixing leveling feet on the surface you may need.

Dimensions of holes are also available by request.

Furco Industrial

Optional Plate

LEVELING FEET

OPTIONAL SWIVEL TYPE

WITH ANTI-VIBRATION RUBBER PAD

SECTION

VIEW

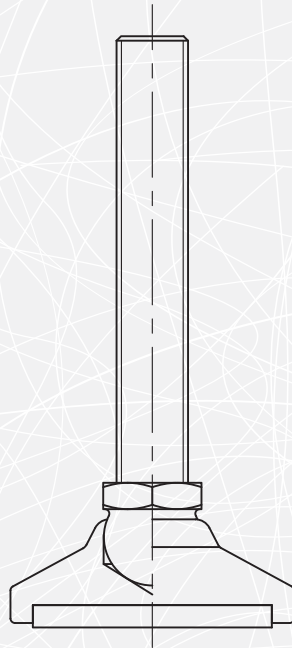

RUBBER

PAD

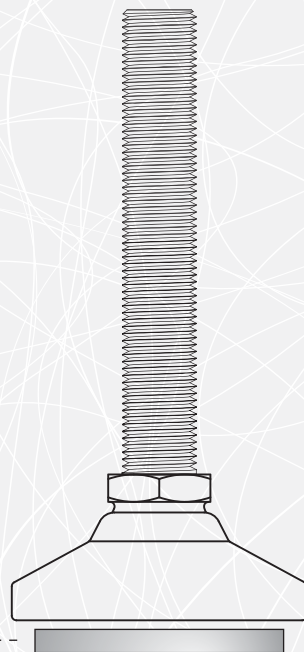

Optional Plate with anti-Vibration Rubber Pad provides vibration isolation and shock attenuation.

Furco Industrial

Specification

LEVELING FEET

STANDARD NON-SWIVEL TYPE

| Model | Base Plate | | Spindle Size | | | Nut | |
|-------------|------------|------|--------------|-----|-------|------|------|
| | ΦD | H1 | Thread | H2 | H3 | H4 | A/F |
| | 19 | 8.7 | #10-32 | 3.1 | 25.4 | 3.1 | 9.5 |
| | 25 | 11.5 | #1/4-20 | 4.5 | 31.7 | 4 | 12.7 |
| | 31.5 | 15 | #3/8-16 | 5.9 | 50.8 | 4 | 15.8 |
| | 31.5 | 15 | #3/8-16 | 5.9 | 101.6 | 4 | 15.8 |
| | 31.5 | 15 | M10x1.5P | 5.9 | 50 | 4 | 15.8 |
| | 31.5 | 15 | M10x1.5P | 5.9 | 100 | 4 | 15.8 |
| | 31.5 | 15 | #5/16-18 | 5.9 | 50.8 | 4 | 15.8 |
| | 47.6 | 20 | #1/2-13 | 6.6 | 50.8 | 9.5 | 19 |
| | 47.6 | 20 | #1/2-13 | 6.6 | 101.6 | 9.5 | 19 |
| | 47.6 | 20 | M12x1.75P | 6.6 | 50 | 9.5 | 19 |
| | 47.6 | 20 | M12x1.75P | 6.6 | 100 | 9.5 | 19 |
| | 63 | 23 | #5/8-11 | 5.9 | 50.8 | 9.5 | 22 |
| | 63 | 23 | #5/8-11 | 5.9 | 101.6 | 9.5 | 22 |
| | 63 | 23 | M16x2P | 5.9 | 50 | 9.5 | 22 |
| | 63 | 23 | M16x2P | 5.9 | 100 | 9.5 | 22 |
| | 76 | 25.5 | #3/4-10 | 9.1 | 50.8 | 10.5 | 27 |
| | 76 | 25.5 | #3/4-10 | 9.1 | 101.6 | 10.5 | 27 |
| | 76 | 25.5 | M20x2.5P | 9.1 | 50 | 10.5 | 27 |
| | 76 | 25.5 | M20x2.5P | 9.1 | 100 | 10.5 | 27 |
| | 101 | 30 | #1-8 | 13 | 108 | 13.5 | 36 |
| | 101 | 30 | #1-8 | 13 | 203.2 | 13.5 | 36 |
| | 101 | 30 | M24x3P | 13 | 108 | 13.5 | 36 |
| | 101 | 30 | M24x3P | 13 | 203 | 13.5 | 36 |
| custom-made | | | | | | | |

unit :mm

